

END SHACLE

エンドシャックル (JIS F 3303-2010)

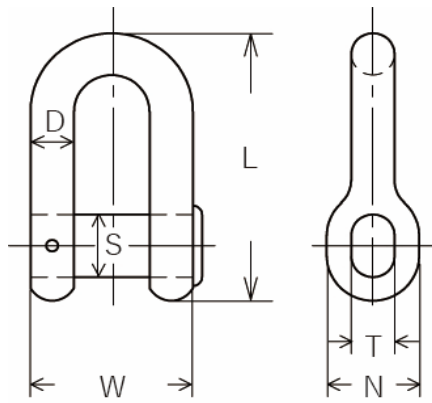

呼び径 mm	径 (Diameter)		外長 (Length)			外幅 (Width)			S	N	T	重量
	標準	最大	最小	標準	最大	最小	標準	最大				
16	22.4	23.5	140.4	144.0	147.6	78.8	80.8	82.8	33.6	48.0	22.4	2.0
19	26.6	27.9	166.7	171.0	175.3	93.6	96.0	98.3	39.9	57.0	26.6	3.0
20.5	28.7	30.1	179.9	184.5	189.1	100.9	103.5	106.1	43.1	61.5	28.7	4.3
22	30.8	32.3	193.1	198.0	203.0	108.3	111.1	113.9	46.2	66.0	30.8	5.0
24	33.6	35.3	210.6	216.0	221.4	118.2	121.2	124.2	50.4	72.0	33.6	6.5
25	35.0	36.8	219.4	225.0	230.6	123.1	126.3	129.4	52.5	75.0	35.0	7.0
26	36.4	38.2	228.2	234.0	239.9	128.0	131.3	134.6	54.6	78.0	36.4	8.0
28	39.2	41.2	245.7	252.0	258.3	137.9	141.4	144.9	58.8	84.0	39.2	10.0
30	42.0	44.1	263.3	270.0	276.8	147.7	151.5	155.3	63.0	90.0	42.0	14.0
32	44.8	47.0	280.8	288.0	295.2	157.6	161.6	165.6	67.2	96.0	44.8	15.5
34	47.6	50.0	298.4	306.0	313.7	167.4	171.7	176.0	71.4	102.0	47.6	17.0
36	50.4	52.9	315.9	324.0	332.1	177.3	181.8	186.3	75.6	108.0	50.4	20.0
38	53.2	55.9	333.5	342.0	350.6	187.1	191.9	196.7	79.8	114.0	53.2	23.0
40	56.0	58.8	351.0	360.0	369.0	197.0	202.0	207.1	84.0	120.0	56.0	26.0
42	58.8	61.7	368.6	378.0	387.5	206.8	212.1	217.4	88.2	126.0	58.8	30.0
44	61.6	64.7	386.1	396.0	405.9	216.6	222.2	227.8	92.4	132.0	61.6	35.0
46	64.4	67.6	403.7	414.0	424.4	226.5	232.3	238.1	96.6	138.0	64.4	40.0
48	67.2	70.6	421.2	432.0	442.8	236.3	242.4	248.5	100.8	144.0	67.2	45.0
50	70.0	73.5	438.8	450.0	461.3	246.2	252.5	258.8	105.0	150.0	70.0	55.0
52	72.8	76.4	456.3	468.0	479.7	256.0	262.6	269.2	109.2	156.0	72.8	60.0
54	75.6	79.4	473.9	486.0	498.2	265.9	272.7	279.5	113.4	162.0	75.6	45.0
56	78.4	82.3	491.4	504.0	516.6	275.7	282.8	289.9	117.6	168.0	78.4	70.0
58	81.2	85.3	509.0	522.0	535.1	285.6	292.9	300.2	121.8	174.0	81.2	80.0
60	84.0	88.2	526.5	540.0	553.5	295.4	303.0	310.6	126.0	180.0	84.0	90.0
62	86.8	91.1	544.1	558.0	572.0	305.3	313.1	320.9	130.2	186.0	86.8	100.0
64	89.6	94.1	561.6	576.0	590.4	315.1	323.2	331.3	134.4	192.0	89.6	115.0
66	92.4	97.0	579.2	594.0	608.9	325.0	333.3	341.6	138.6	198.0	92.4	130.0
68	95.2	100.0	596.7	612.0	627.3	334.8	343.4	352.0	142.8	204.0	95.2	140.0
70	98.0	102.9	614.3	630.0	645.8	344.7	353.5	362.3	147.0	210.0	98.0	150.0
73	102.2	107.3	640.6	657.0	673.4	359.4	368.7	377.9	153.3	219.0	102.2	165.0
76	106.4	111.7	666.9	684.0	701.1	374.2	383.8	393.4	159.6	228.0	106.4	185.0